

2	2	2	2	2	2	2	2	2	2	2	2
1	4	4	4	7	7	7	10	10	10	10	3
1	4	4	4	7	7	7	10	10	10	10	3
1	4	4	4	7	7	7	10	10	10	10	3
1	5	5	5	8	8	8	11	11	11	11	3
1	5	5	5	8	8	8	11	11	11	11	3
1	5	5	5	8	8	8	11	11	11	11	3
1	6	6	6	9	9	9	12	12	12	12	3
1	6	6	6	9	9	9	12	12	12	12	3
1	6	6	6	9	9	9	12	12	12	12	3

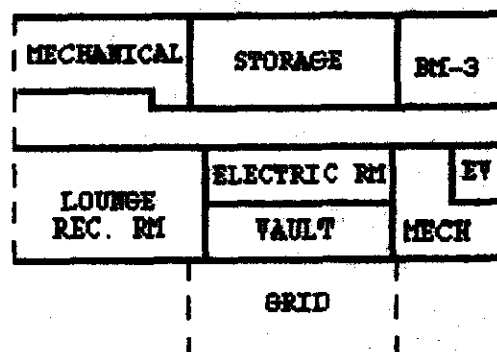

# GRID SECTION RESULTS IN (mg/Kg)

1	1.6
2	ND
3	ND
4	2.6
* 5	110.0
6	9.2
7	1.2
8	1.1
9	ND
10	ND
11	ND
12	ND



GRID LOCATION DETAIL

\* NOTE: GRID SECTION #5 WAS ADVANCED TO THE LEVEL OF TWO FEET. THE RESULT WAS (ND).

## KEY

ND = NON-DETECT

mg/Kg = MILLIGRAM PER KILOGRAM

NOTE: ALL SAMPLES TAKEN AT ONE FOOT UNLESS OTHERWISE NOTED.

1	SUNY GAGE HALL	AN			
ISSUE	DESCRIPTION	ORIGIN	NO.	APPR.	DATE

**CleanHarbor**

ENVIRONMENTAL SERVICES, INC  
325 Wood Road

Braintree, Massachusetts 02184  
Telephone (617) 849-1800

GAGE HALL INITAIL EXTERNAL  
EXCAVATION GRID PCB SAMPLE  
RESULTS.

PROJECT NO. NY5069  
SCALE HTS

DWG. NO. SUNY-021-V5



ENVIRONMENTAL SERVICES COMPANIES

24 HOUR SERVICE

P.O. BOX 1812

ALBANY, N.Y. 12201

(518) 434-0149

February 26, 1992

Mr. Dean N. Palen, P.E., MBA  
Director of Environmental Sanitation Division  
Ulster County Health Department  
300 Flatbush Ave.  
Kingston, New York 12401

Please find attached the plans for cleaning and opening the following buildings on the State University of New York campus in New Paltz:

Building: Scudder Hall

Revision 3.2

I have received, reviewed and approved this plan.

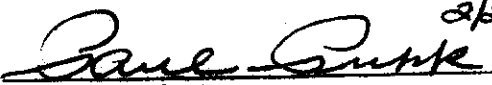
  
Paul Pukk  
Clean Harbors of Kingston

I have inspected the completed work and it meets my approval.

  
Paul Pukk  
Clean Harbors of Kingston

  
Dean N. Palen, P.E., MBA  
Ulster County Health Dept.

  
Dean N. Palen, P.E., MBA  
Ulster County Health Dept.

  
Kristine Edwards  
NYS Office of General Services

  
Kristine Edwards  
NYS Office of General Services

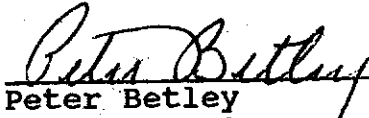
  
Peter Betley  
SUNY New Paltz  
Coord. Env. Health & Safety

  
Peter Betley  
SUNY New Paltz  
Coord. Env. Health & Safety

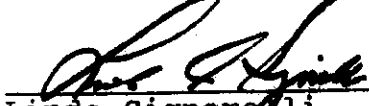
  
Lindo Signorelli  
SUNY  
Facilities Mgt. & Support

  
Lindo Signorelli  
SUNY  
Facilities Mgt. & Support

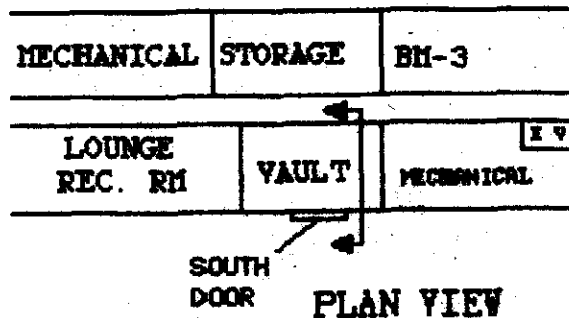
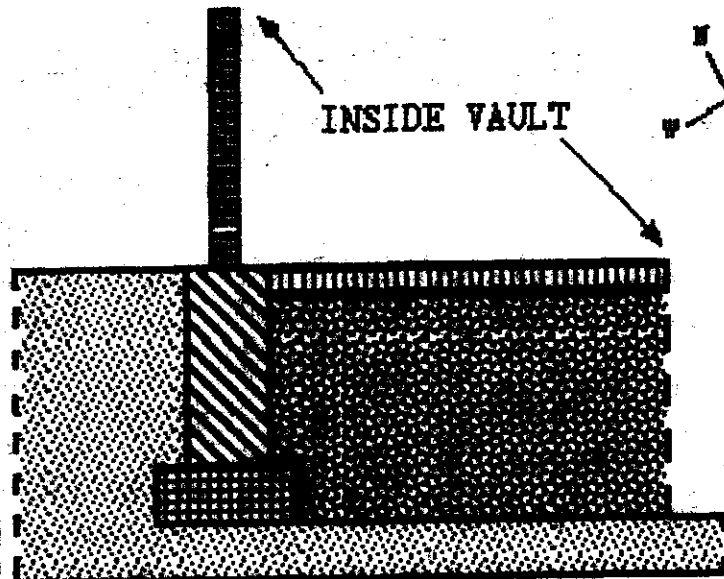

SOUTH WALL	NORTH WALL	EAST WALL	WEST WALL	CEILING	SOUTH GRADE BEAM	SOUTH DOOR
16	26	56	24	1.0	41	32
46	64	58	20		140	
22 (WEST HALF OF WALL)					450 (CHIP)*	
26 (WEST HALF OF WALL)					940 (CHIP)*	
40 (EAST HALF OF WALL)						
21 (EAST HALF OF WALL)						

ALL PCB SAMPLES IN THE AREA SHOWN WERE WIPE SAMPLES EXCEPT FOR THE SOUTH GRADE BEAMS MARKED WITH AN ASTERISK "\*\*". THESE INDICATE CHIP SAMPLES. THE SAMPLE RESULTS ARE GIVEN IN  $\mu\text{g}/100 \text{ sq cm}$ . THE REMAINING TWO CHIP SAMPLE RESULTS ARE GIVEN IN  $\text{mg}/\text{Kg}$ .

#### KEY

$\text{mg}/\text{Kg}$  = MILLIGRAM PER KILOGRAM

1	SUNY GAGE HALL	NY			
ISSUE	DESCRIPTION	ORIGIN	NO.	APPR.	DATE

# CleanHarbors

ENVIRONMENTAL SERVICES, INC

325 Wood Road

Braintree, Massachusetts 02184

Telephone (617) 849-1800

GAGE HALL VAULT PRE-CLEAN  
GRADE BEAM, WALL, AND DOOR  
PCB SAMPLE RESULTS.

PROJECT NO NY5068

SCALE NTS

DWG. NO.

SUNY-021-V6

# SHAFT

3rd FLOOR	0.7	
2nd FLOOR	2.2	
1st FLOOR	0.1	
BASEMENT		

BUILDING SIDE VIEW (NTS)

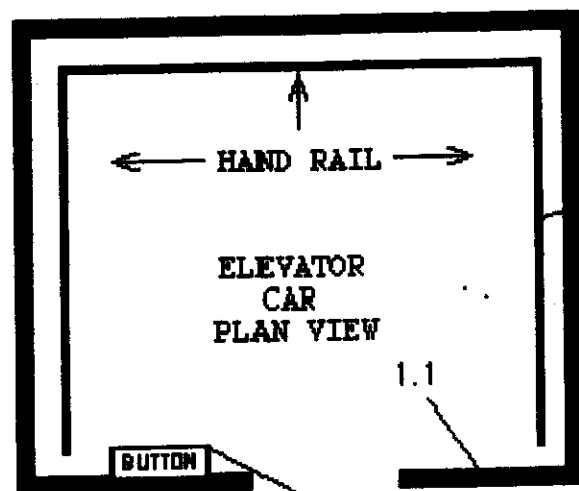

2.6

KEY  
UNITS IN ug/100 sq cm  
NOTE: ALL SAMPLES ARE 1260  
UNLESS NOTED.

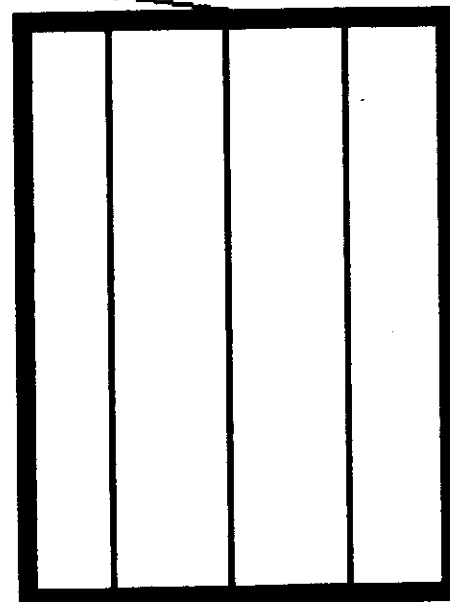

ELEVATOR  
CAR  
FRONT VIEW

1	SUNY GAGE HALL	NV			
ISSUE	DESCRIPTION	CRITICAL NO.	APPR.	DATE	

## CleanHarbor

ENVIRONMENTAL SERVICES, INC  
325 Wood Road  
Braintree, Massachusetts 02184  
Telephone (617) 849-1800

GAGE HALL PRE-CLEAN ELEVATOR  
SHAFT AND ELEVATOR CAR PCB WIPE  
SAMPLE RESULTS.

PROJECT NO. NY5068  
SCALE NTS

DWG. NO. SUNY-021-V7

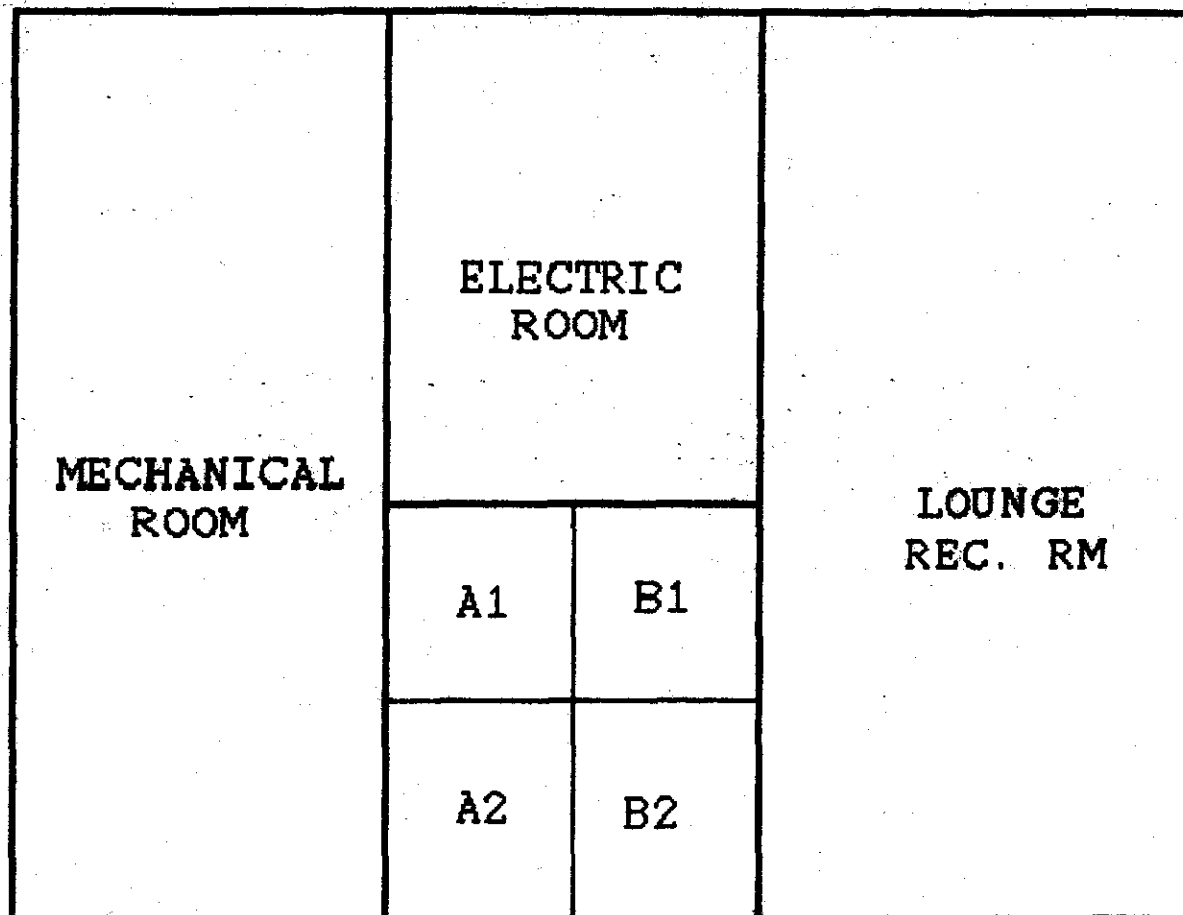

SAMPLE LOCATION	DEPTH (FEET)	RESULTS IN ppm (mg/Kg)
A1	1'6"	47.0
A2	1'6"	3.0
B1	1'6"	40.0
B2	1'6"	1600.0



#### KEY

ppm = PARTS PER MILLION  
mg/Kg = MILLIGRAM PER KILOGRAM  
T.O.S. = TOP OF SLAB

1	SUNY GAGE HALL	REV			
ISSUE	DESCRIPTION	DATE	BY	CHKD.	DATE

**CleanHarbors**

ENVIRONMENTAL SERVICES, Inc.

325 Wood Road

Braintree, Massachusetts 02184

Telephone (617) 849-1800

GAGE HALL VAULT GRID EXCAVATION  
PCB SAMPLE RESULTS. SAMPLES  
COLLECTED ON 6/16/92. 1'6"  
BELOW T.O.S.

PROJECT NO. NY3068

SCALE NTS

DWG. NO.

SUNY-021-V1

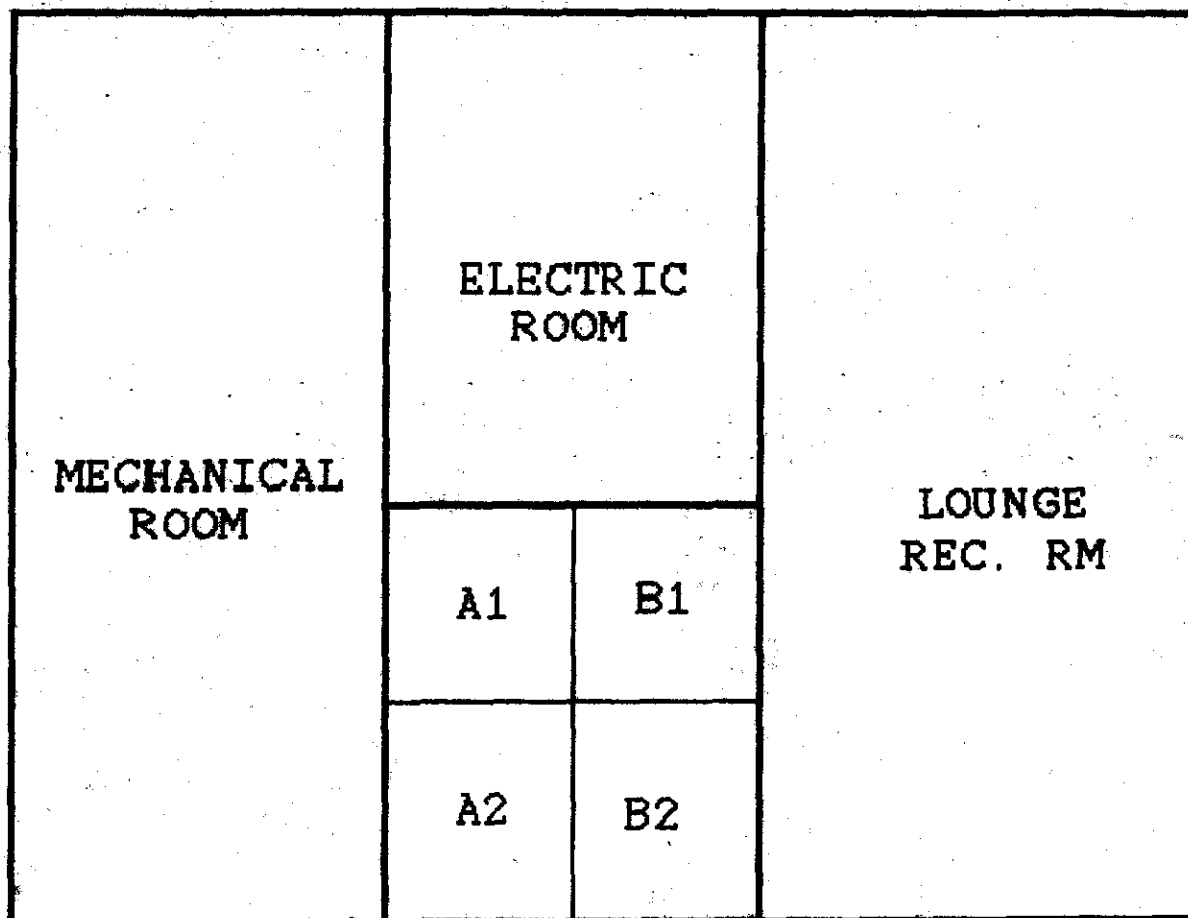

SAMPLE LOCATION	DEPTH (FEET)	RESULTS IN ppm (mg/Kg)
A1	3'3"	9.7
A2	3'3"	30.0
B1	3'3"	4.2
B2	3'7"	1.2



# **KEY**

ppm = PARTS PER MILLION  
mg/Kg = MILLIGRAM PER KILOGRAM  
T.O.S. = TOP OF SLAB

1	SUNY GAGE HALL	REV			
ISSUE	DESCRIPTION	BY	CHKD.	DATE	

**CleanHarbor**

ENVIRONMENTAL SERVICES, Inc.  
325 Wood Road  
Braintree, Massachusetts 02184  
Telephone (617) 849-1800

GAGE VAULT EXCAVATION GRID-DEPTH  
OF 3'3" AND 3'7" BELOW T.O.S.  
PCB SAMPLES COLLECTED 6/23/92

PROJECT NO. WTS068  
SCALE NTS

DWG. NO. SUNY-021-V2

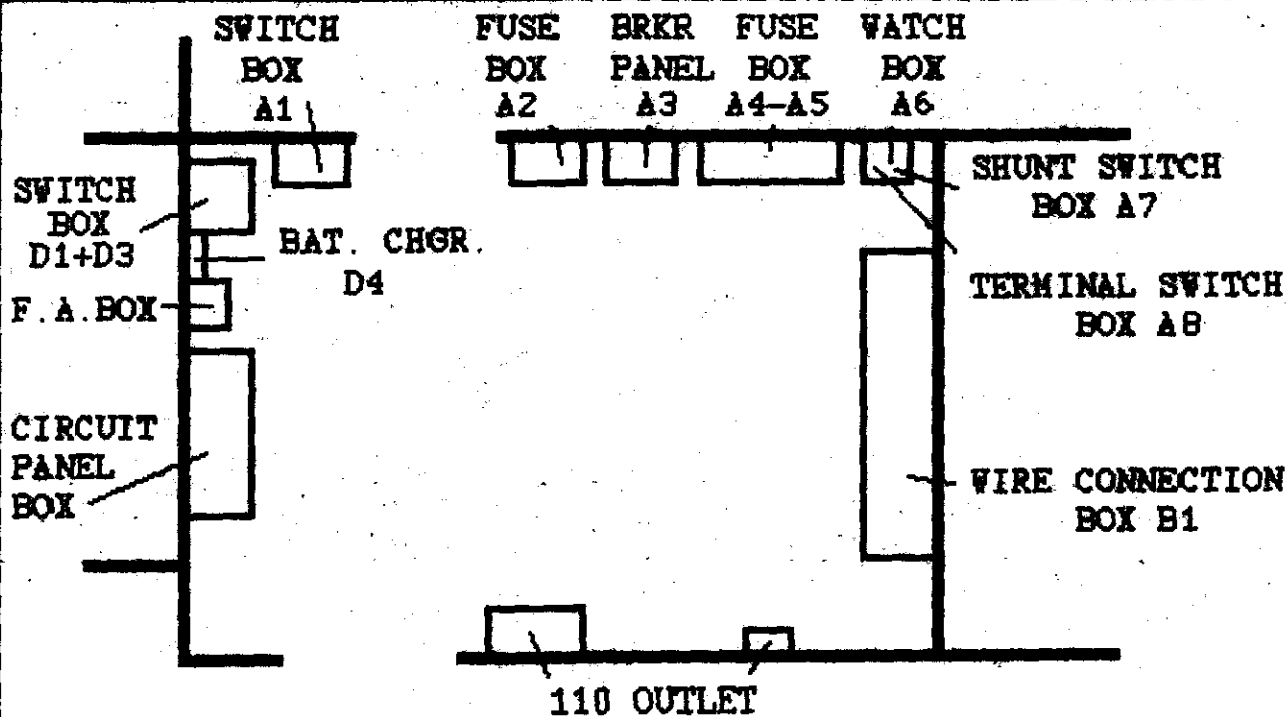

KEY  
UNITS IN  $\mu\text{g}/100 \text{ sq. cm}$

LOCATION	RESULTS
A1 SWITCH BOX	4900 as 1260
A2 FUSE BOX	480 as 1260
A3 BREAKER PANEL	41 as 1260
A4 INSIDE OF FUSE BOX	160 as 1260
A5 INSIDE OF FUSE BOX	100 as 1260
A6 INSIDE OF WATCH BOX	1100 as 1260
A7 SHUNT SWITCH BOX	1100 as 1260
A8 INSIDE TERMINAL SWITCH	200 as 1260
B1 INSIDE WIRE CONN. BOX	2.2 as 1260
D1 INSIDE SWITCH BOX	11 as 1260
D3 INSIDE SWITCH BOX	67 as 1260
D4 INSIDE BATTERY CHGR BOX	25 as 1260
INSIDE CIRCUIT PANEL BOX	17 as 1260
FIRE ALARM BOX	480 as 1260

#### ELECTRICAL ROOM DETAIL

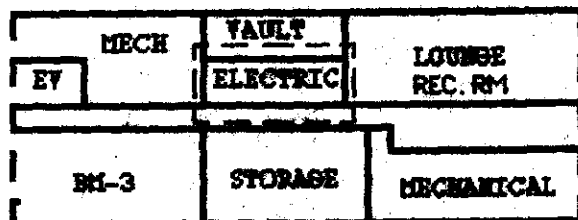

1	SUNY GAGE HALL	NV			
ISSUE	DESCRIPTION	BY	CHKD.	DATE	

GAGE HALL PRE-CLEAN ELECTRIC  
ROOM PCB WIPE SAMPLE RESULTS.

**CleanHarbor**

ENVIRONMENTAL SERVICES, INC  
325 Wood Road  
Braintree, Massachusetts 02104  
Telephone (617) 849-1800

PROJECT NO. NY5069  
SCALE NTS

DWG. NO. SUNY-021-EL1

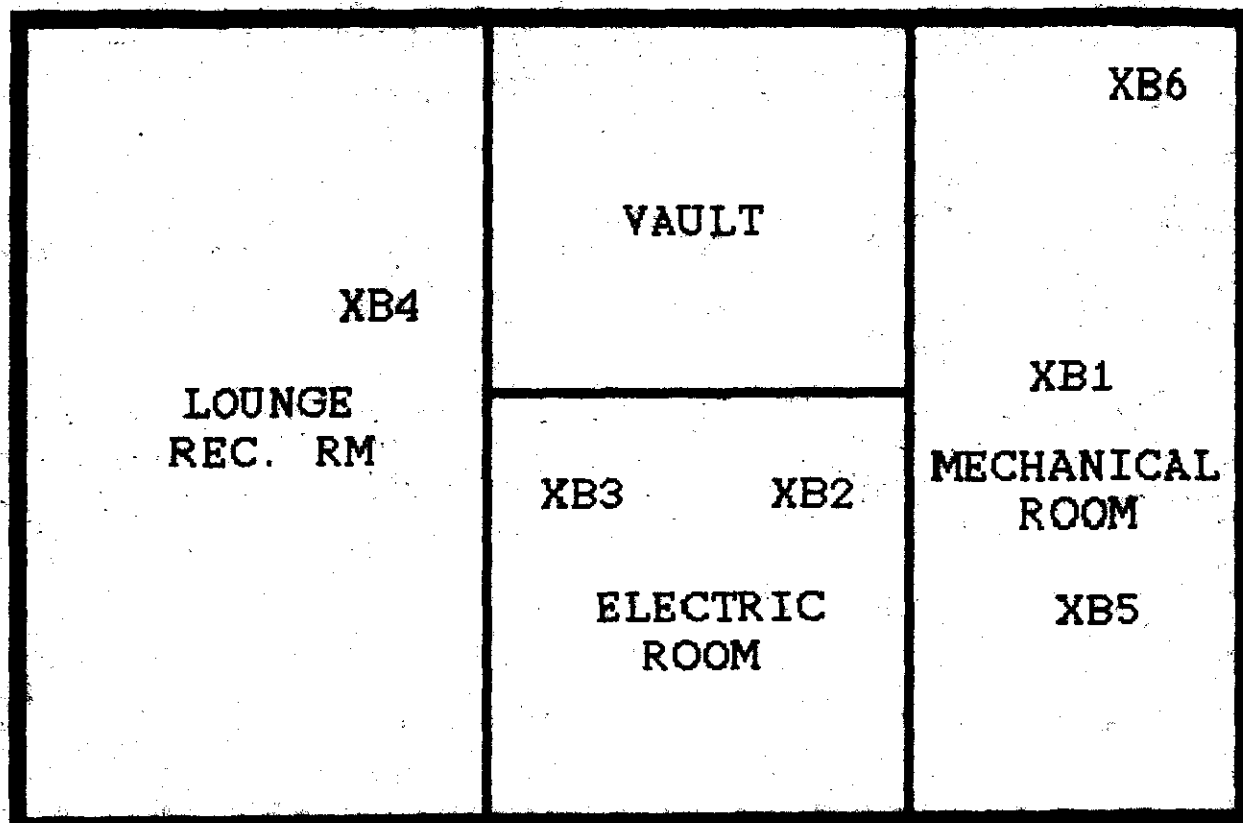

SAMPLE LOCATION	DEPTH (FEET)	RESULTS IN ppm (mg/Kg)
-----------------	--------------	---------------------------

B1	0-1	ND
B1	1-2	1.4
B2	0-1	ND
B2	1-2	1.1
B2	2-3	2.8
B3	0-1	ND
B3	1-2	ND
B3	2-3	ND
B4	0-1	ND
B4	1-2	ND
B5	0.5-1	ND
B5	1-2	ND
B5	2-3	ND
B5	3-25	ND
B6	0.5-1	ND
B6	1-2	ND
B6	2-3	ND

# KEY

ppm = PARTS PER MILLION  
mg/Kg = MILLIGRAM PER KILOGRAM  
T.O.S. = TOP OF SLAB

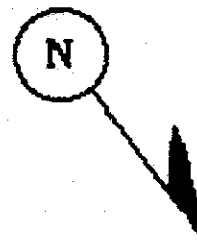

1	SUNY GAGE HALL	NY			
ISSUE	DESCRIPTION	DATE	NO.	APPR.	DATE

**CleanHarbor**

ENVIRONMENTAL SERVICES, INC  
325 Wood Road  
Braintree, Massachusetts 02184  
Telephone (617) 849-1800

GAGE HALL VAULT PERIMETER SPLIT-  
SPOON PCB SAMPLE RESULTS  
SAMPLES COLLECTED 6/17/92

PROJECT NO. NY5068  
SCALE NTS

DWG. NO. SUNY-021-V3



ELECTRIC  
ROOM

LOUNGE  
REC. RM

MECHANICAL  
ROOM

XA1

XA2

VAULT

XA3

XA4

XA5

XA6

XA7

XA8

LOCATION	(FEET)	RESULT
A1	2' 6"	ND
A2	2' 6"	4.2
A3	2' 6"	23.0
A4	3"	1.1
A5	2'-3'	24.0
A6	3'-4'	2.7
A7	2'-3'	ND
A8	3'-4'	ND

KEY

UNITS IN mg/Kg

ND = NON-DETECT



1	SUNY GAGE HALL	AN			
ISSUE	DESCRIPTION	DATE	BY	DATE	DATE

**CleanHarbor**

ENVIRONMENTAL SERVICES, INC.

325 Wood Road

Braintree, Massachusetts 02184

Telephone (617) 849-1800

GAGE HALL VAULT EXCAVATION SPLIT-  
SPOON PCB SAMPLE RESULTS.  
SAMPLES TAKEN 6/9/92

PROJECT NO. NY5068

SCALE WTS

DWG. NO.

SUNY-021-V4